

BOROUGH OF BLACKPOOL  
TOWN AND COUNTRY PLANNING ACT 1971

(16)

BOROUGH OF BLACKPOOL (LAND AT 145 AND 147 NEWTON DRIVE)

TREE PRESERVATION ORDER 1979

TP45/18/15.

THE BLACKPOOL BOROUGH COUNCIL, in this Order called "the authority" in pursuance of the powers conferred in that behalf by Section 60 of the Town and Country Planning Act 1971 and subject to the provisions of the Forestry Act 1967, hereby makes the following Order:-

1. In this Order -

"the Act" means the Town and Country Planning Act 1971;

"owner" means the owner in fee simple, either in possession or who has granted a lease or tenancy of which the unexpired portion is less than three years; lessee (including a sub-lessee) or tenant in possession, the unexpired portion of whose lease or tenancy is three years or more; and a mortgagee in possession; and

"the Secretary of State" means the Secretary of State for the Environment.

2. Subject to the provisions of this Order and to the exemptions specified in the Second Schedule hereto, no person shall, except with the consent of the authority and in accordance with the conditions, if any, imposed on such consent, cut down, top, lop, uproot, wilfully damage or wilfully destroy or cause or permit the cutting down, topping, lopping, uprooting, wilful damage or wilful destruction of any tree specified in the First Schedule hereto or comprised in a group of trees or in a woodland therein specified, the position of which trees, groups of trees and woodlands is defined in the manner indicated in the said First Schedule on the map annexed hereto, which map shall, for the purpose of such definition as aforesaid, prevail where any ambiguity arises between it and the specification in the said First Schedule.

3. An application for consent made to the authority under Article 2 of this Order shall be in writing stating the reasons for making the application, and shall by reference if necessary to a plan specify the trees to which the application relates, and the operations for the carrying out of which consent is required.

4. (1) Where an application for consent is made to the authority under this Order, the authority may grant such consent either unconditionally, or subject to such conditions (including conditions requiring the replacement of any tree by one or more trees on the site or in the immediate vicinity thereof), as the authority may think fit, or may refuse consent;

Provided that where the application relates to any woodland specified in the First Schedule to this Order the authority shall grant consent so far as accords with the principles of good forestry, except where, in the opinion of the authority, it is necessary in the interests of amenity to maintain the special character of the woodland or the woodland character of the area, and shall not impose conditions on such consent requiring replacement or replanting.

(2) The authority shall keep a register of all applications for consent under this Order containing information as to the nature of the application, the decision of the authority thereon, any compensation awarded in consequence of such decision and any directions as to replanting of woodlands; and every such register shall be available for inspection by the public at all reasonable hours.

NOTE

If it is desired to fell any of the trees included in this Order, and the trees are trees for the felling of which a licence is required under the Forestry Act 1967, application should be made not to the authority for consent under this Order but to the Conservator of Forests for a licence under that Act (Section 15(5)).

5. Where the authority refuse consent under this Order or grant such consent subject to conditions they may when refusing or granting consent certify in respect of any trees for which they are so refusing or granting consent that they are satisfied -

- (a) that the refusal or condition is in the interests of good forestry; or
- (b) that the trees have an outstanding or special amenity value.

6. Where consent is granted under this Order to fell any part of a woodland other than consent for silvicultural thinning then unless -

- (a) such consent is granted for the purpose of enabling development to be carried out in accordance with a permission to develop land under Para III of the Act, or
- (b) the authority with the approval of the Minister dispense with replanting, the authority shall give to the owner of the land on which that part of the woodland is situated a direction in writing specifying the manner in which and the time within which he shall replant such land and where such a direction is given and the part is felled the owner shall, subject to the provision of this Order and section 25 of the Countryside Act 1968, replant the said land in accordance with the direction.

(2) Any direction given under paragraph (1) of this Article may include requirements as to -

- (a) species;
- (b) number of trees per acre;
- (c) the erection and maintenance of fencing necessary for protection of the replanting;
- (d) the preparation of ground, draining, removal of brushwood, lop and top; and
- (e) protective measures against fire.

7. On imposing any condition requiring the replacement of any tree under Article 4 of the Order, or on giving a direction under Article 6 of this Order with respect to the replanting of woodlands, the authority shall if such condition or direction relates to land in respect of which byelaws made by a river authority, a drainage board, the Conservators of the River Thames or the Lee Conservancy Catchment Board restrict or regulate the planting of trees, notify the applicant or the owner of the land, as the case may be, of the existence of such byelaws and that any such condition or direction has effect subject to the requirements of the river authority, drainage board, the Conservators of the River Thames or the Lee Conservancy Catchment Board under those byelaws and the condition or direction shall have effect accordingly.

8. The provisions set out in the Third Schedule to this Order, being provisions of Part III of the Act adapted and modified for the purposes of this Order, shall apply in relation thereto.

9. Subject to the provisions of this Order, any person who has suffered loss or damage in consequence of any refusal (including revocation or modification) of consent under this Order or of any grant of any such consent subject to conditions, shall, if he makes a claim on the authority within the time and in the manner prescribed by this Order, be entitled to recover from the authority compensation in respect of such loss or damage:

Provided that no compensation shall be payable in respect of loss or damage suffered by reason of such refusal or grant of consent in the case of any trees the subject of a certificate in accordance with Article 5 of this Order.

10. In assessing compensation payable under the last preceding Article account shall be taken of:-

- (a) any compensation or contribution which has been paid whether to the claimant or any other person, in respect of the same trees under the terms of this or any other Tree Preservation Order under Sections 60 or 61 of the Act or under the terms of any Interim Preservation Order made under Section 8 of the Town and Country

Planning (Interim Development) Act 1943, or any compensation which has been paid or which could have been claimed under any provision relating to the preservation of trees or protection of woodlands contained in an operative scheme under the Town and Country Planning Act 1932, and

- (b) any injurious affection to any land of the owner which would result from the felling of the trees the subject of the claim.

11. (1) A claim for compensation under this Order shall be in writing and shall be made by serving it on the authority, such service to be effected by delivering the claim at the offices of the authority addressed to the Clerk thereof or by sending it by prepaid post so addressed.

(2) The time within which any such claim shall be made as aforesaid shall be a period of twelve months from the date of the decision of the authority, or of the Minister, as the case may be, or where an appeal has been made to the Minister against the decision of the authority, from the date of the decision of the Minister on the appeal.

12. Any question of disputed compensation shall be determined in accordance with the provisions of Section 179 of the Act.

NOTE

Any person contravening the provisions of this Order by cutting down, uprooting or wilfully destroying a tree, or by wilfully damaging, topping or lopping a tree in such manner as to be likely to destroy it is guilty of an offence and liable on summary conviction to a fine not exceeding £1000 or twice the sum which appears to the Court to be the value of the tree, whichever is the greater, or on indictment to a fine. The penalty for any other contravention of this Order is a fine not exceeding £200 on summary conviction and, in the case of a continuing offence when the contravention is continued after conviction, a person is liable on summary conviction to an additional fine not exceeding £5 for every day on which the contravention is so continued.

If a tree other than one to which an Order applies as part of a woodland is removed, uprooted or destroyed in contravention of an Order or is removed, uprooted or destroyed or dies at a time when its cutting down or uprooting is authorised only by Section 60(6) of the Town and Country Planning Act 1971 relating to trees which are dying or dead or have become dangerous, it is the duty of the owner of the land, unless on his application the local planning authority dispense with the requirement, to plant another tree of appropriate size and species at the same place as soon as he reasonably can. Except in emergency, not less than 5 days previous notice of the removal, etc. should be given to the authority to enable the latter to decide whether or not to dispense with the requirement.

FIRST SCHEDULE

TREES SPECIFIED INDIVIDUALLY

CIRCLED IN BLACK ON THE MAP

<u>Number on Map</u>	<u>Description</u>	<u>Situation</u>
1	Sycamore	145 Newton Drive
2	Ash	" " "
3	Sycamore	" " "
4	Sycamore	" " "
5	Ash	" " "
6	Sycamore	" " "
7	Ash	" " "
8	Ash	" " "
9	Sycamore	" " "
10	Ash	" " "

Continued ..

FIRST SCHEDULE (CONTINUED)

<u>Number on Map</u>	<u>Description</u>	<u>Situation</u>
11	Ash	145 Newton Drive
12	Sycamore	" " "
13	Sycamore	" " "
14	Sycamore	" " "
15x	Willow	" " "
16	Sycamore	" " "
17	Sycamore	" " "
18	Horse Chestnut	" " "
19	Sycamore	" " "
20	Sycamore	" " "
21	Sycamore	" " "
22	Sycamore	" " "
23	Sycamore	" " "
24	Plum (Ornamental)	147 Newton Drive
24A	Holly	" " "
25	Plum (Ornamental)	" " "
26x	Laburnum	" " "
27	Holly	" " "
28	Holly	" " "
29	Holly	" " "
30	Holly	" " "
31	Holly	" " "
33	Laburnum	" " "
34	Laburnum	" " "
35	Sycamore	" " "
36	Laburnum	" " "
37	Cherry (Ornamental)	" " "
38	Sycamore	145 Newton Drive
39	Sycamore	" " "
40	Sycamore	" " "
41	Sycamore	" " "
42	Sycamore	" " "
43	Sycamore	" " "
44	Sycamore	" " "
45	Pear	" " "
46	Sycamore	" " "
47	Sycamore	" " "
48	Sycamore	" " "
49	Sycamore	" " "
50	Sycamore	" " "
51	Laburnum	" " "
52	Elm	" " "
53	Sycamore	" " "
54	Sycamore	" " "
55	Sycamore	" " "
56	Sycamore	" " "
57	Sycamore	" " "
58	Sycamore	" " "
59	Elm	" " "
60	Sycamore	" " "
61	Elm	" " "
62	Elm	" " "
63x	Sycamore	" " "
64x	Sycamore	" " "
65x	Elm	" " "
66	Poplar	" " "
67	Poplar	" " "
68	Sycamore	" " "

Continued ..

FIRST SCHEDULE (CONTINUED)

<u>Number on Map</u>	<u>Description</u>	<u>Situation</u>
69	Elm	145 Newton Drive
70	Sycamore	" " "
71	Willow	" " "
72	Horse Chestnut	" " "
73	Horse Chestnut	" " "
74	Horse Chestnut	" " "
75	Willow	" " "
76	Horse Chestnut	" " "
77	Horse Chestnut	" " "
78	Willow	" " "
79	Sycamore	" " "
80	Apple	" " "
81	Apple	" " "
82	Poplar	" " "
83	Apple	" " "
84	Sycamore	" " "
85	Sycamore	" " "
86	Sycamore	" " "
87	Willow	" " "
88	Horse Chestnut	" " "
89	Sycamore	" " "
90	Poplar	" " "
91	Poplar	" " "
92	Poplar	" " "
93	Poplar	" " "
94	Poplar	" " "
95	Poplar	" " "
96	Poplar	" " "
97	Poplar	" " "
98	Poplar	" " "
99	Poplar	" " "
100	Poplar	" " "
101	Poplar	" " "
102	Poplar	" " "
103	Poplar	" " "
104x	Poplar	" " "
105x	Poplar	" " "
106	Poplar	" " "
107	Sycamore	147 Newton Drive
108	Sycamore	" " "
109	Apple	" " "
110	Apple	" " "
111	Apple	" " "
112	Sycamore	" " "
113	Sycamore	" " "
114	Pear	" " "
115	Holly	" " "
116	Apple	" " "
117	Apple	" " "
118	Apple	" " "
119	Lilac	" " "
120	Laburnum	" " "
121	Laburnum	" " "
122	Cherry (Ornamental)	" " "

TREES SPECIFIED BY REFERENCE TO AN AREA

<u>No. on Map</u>	<u>Description</u>	<u>Situation</u>
-------------------	--------------------	------------------

NONE

GROUPS OF TREES

NONE

WOODLANDS

NONE

SECOND SCHEDULE

This Order shall not apply so as to require the consent of the authority to:

- (1) the cutting down of any tree on land which is subject to a forestry dedication covenant where
  - (a) any positive covenants on that part of the owner of the land contained in the same deed as the forestry dedication covenant and at the time of the cutting down binding on the then owner of the land are fulfilled;
  - (b) the cutting down is in accordance with a plan of operations approved by the Forestry Commission under such deed.
- (2) the cutting down of any tree which is in accordance with a plan of operations approved by the Forestry Commission under the approved woodlands scheme or other grant scheme under section 4 of the Forestry Act 1967 except a scheme which applies to a forestry dedication covenant;
- (3) the cutting down, uprooting, topping or lopping of a tree
  - (a) in pursuance of the power conferred on the Postmaster General by virtue of section 5 of the Telegraph (Construction) Act 1908;
  - (b) by or at the request of -
    - (i) a statutory undertaker where the land on which the trees are situated is operational land as defined by the Act and either works on such land cannot otherwise be carried out or the cutting down, topping or lopping is for the purpose of securing safety in the operation of the undertaking;

- (ii) an electricity board within the meaning of the Electricity Act 1947, where such tree obstructs the construction by the Board of any main transmission line or other electric line within the meaning respectively of the Electricity (Supply) Act 1919 and the Electric Lighting Act 1882 or interferes or would interfere with the maintenance or working of any such line;
  - (iii) a river authority established under the Water Resources Act 1963, a drainage board constituted or treated as having been constituted under the Land Drainage Act 1930, the Conservators of the River Thames or Lee Conservancy Catchment Board where the tree interferes or would interfere with the exercise of any of the functions of such river authority, drainage board, Conservators of the River Thames or Lee Conservancy Catchment Board in relation to the maintenance, improvement or construction of water courses or of drainage works; or
  - (iv) the Minister of Defence for the Royal Air Force, the Minister of Technology or the Board of Trade where in the opinion of such Minister or Board the tree obstructs the approach of aircraft to, or their departure from, any aerodrome or hinders the safe and efficient use of aviation or defence technical installations;
- (c) where immediately required for the purpose of carrying out development authorised by the planning permission granted on an application made under Part III of the Act, or deemed to have been so granted for any of the purposes of that Part;
  - (d) which is a fruit tree cultivated for fruit production growing or standing on land comprised in an orchard or garden.

### THIRD SCHEDULE

Provisions of the following parts of Part III of the Town and Country Planning Act 1971 as adapted and modified to apply to this Order:-

Section 33. (1) Without prejudice to the following provisions as to the revocation or modification of consents, any consent under the Order, including any direction as to replanting given by the authority on the granting of such consent, shall (except in so far as the consent otherwise provides), enure for the benefit of the land and of all persons for the time being interested therein.

#### Reference of applications to the Secretary of State

Section 35. (1) The Secretary of State may give directions to the authority requiring applications for consent under the Order to be referred to him instead of being dealt with by the authority.

(2) A direction under this section may relate either to a particular application or to applications of a class specified in the direction.

(3) Any application in respect of which a direction under this section has effect shall be referred to the Secretary of State accordingly.

(4) Where an application for consent under the Order is referred to the Secretary of State under this section, the provisions of Articles 4 and 5 of the Order shall apply as they apply to an application which falls to be determined by the authority.

(5) Before determining an application referred to him under this Section the Secretary of State shall, if either the applicant or the authority so desire, afford to each of them an opportunity of appearing before, and being heard by, a person appointed by the Secretary of State for the purpose.

(6) The decision of the Secretary of State on any application referred to him under this section shall be final.

(4) The power conferred by this section to revoke or modify a consent may be exercised at any time before the operations for which consent has been given have been completed:

Provided that the revocation or modification of consent shall not affect so much of these operations as had been previously carried out.

(5) Where a notice has been served in accordance with the provisions of subsection (3) of this section, no operations or further operations as the case may be, in pursuance of the consent granted, shall be carried out pending the decision of the Secretary of State under subsection (2) of this section.

Unopposed revocation or modification of consent

(1) The following provisions shall have effect where the local planning authority have made an Order (hereinafter called "such Order") under Section 45 above revoking or modifying any consent granted on an application made under a tree preservation order but have not submitted such Order to the Secretary of State for confirmation by him and the owner and the occupier of the land and all persons who in the authority's opinion will be affected by such Order have notified the authority in writing that they do not object to such Order.

(2) The authority shall advertise the fact that such Order has been made and the advertisement shall specify (a) the period (not less than twenty eight days from the date on which the advertisement first appears) within which persons affected by such Order may give notice to the Secretary of State that they wish for an opportunity of appearing before, and being heard by, a person appointed by the Secretary of State for the purpose and (b) the period (not less than 14 days from the expiration of the period referred to in paragraph (a) above) at the expiration of which, if no such notice is given to the Secretary of State, such Order may take effect by virtue of this section and without being confirmed by the Secretary of State.

(3) The authority shall also serve notices to the same effect on the persons mentioned in subsection (1) above.

(4) The authority shall send a copy of any advertisement published under subsection (2) above to the Secretary of State, not more than three days after the publication.

(5) If within the period referred to in subsection 2(a) above no person claiming to be affected by such Order has given notice to the Secretary of State as aforesaid and the Secretary of State has not directed such Order to be submitted to him for confirmation such Order shall at the expiration of the period referred to in subsection 2(b) of this section take effect by virtue of this section and without being confirmed by the Secretary of State as required by Section 45(2) of this Act.

(6) This section does not apply to such Order revoking or modifying a consent granted or deemed to have been granted by the Secretary of State under Part III, Part IV or Part V of the Town and Country Planning Act 1971.

THE COMMON SEAL of The Blackpool  
Borough Council was hereunto  
affixed this 22<sup>nd</sup> day of  
February 1979 in the  
presence of:—

Mayor

Town Clerk

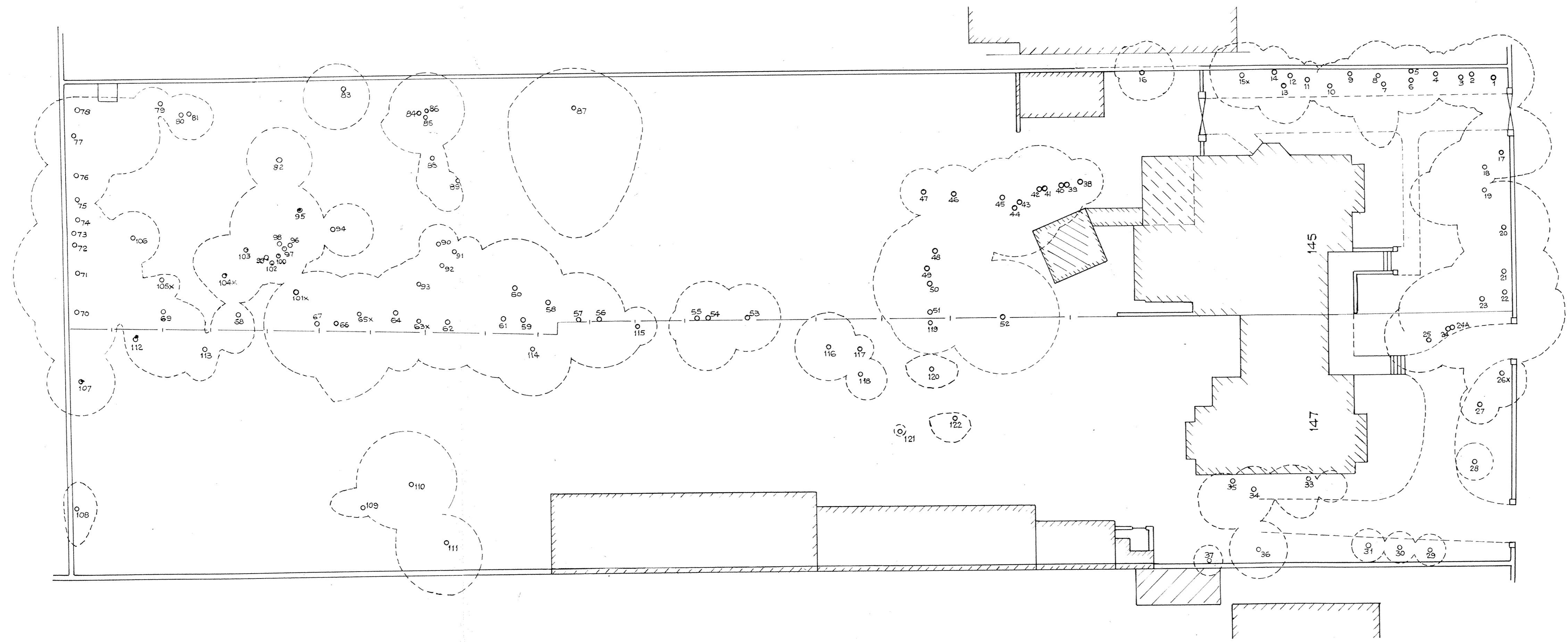

NEWTON DRIVE

Survey	drawn
R.H.	R.S.
date	Erased
31-10-78	J.D.
Scale	
1 : 200	
drawing no.	
E. 6042/20/	

BLACKPOOL BOROUGH COUNCIL

145 & 147 NEWTON DRIVE  
TREE PRESERVATION ORDER 1979

J.S. WILSON, B.Sc, C.Eng, M.I.C.E., M.I.Mun.E., M.I.Struc.E.,  
BOROUGH SURVEYOR